

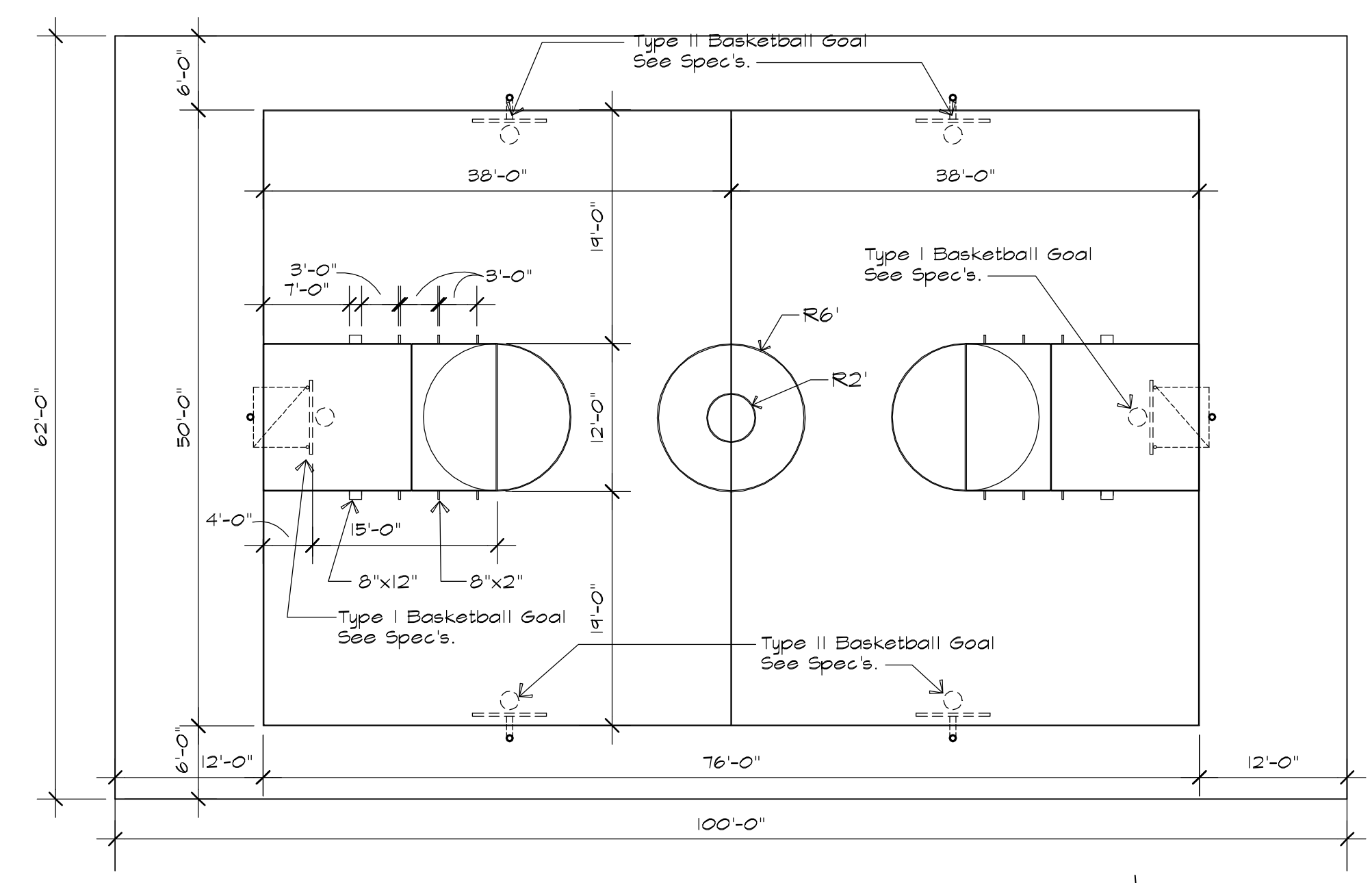

Legend	
Symbol	Description
	Spot Elevation
	Existing Contours
	New Contours
	New Concrete Sidewalks
	Storm Drain
	Fence Line

Date	7/18/08
Revisions	



**1** Court Markings  
**A-2** 3/32" = 1'-0"

Alternate 2  
New Mulched  
Play Area

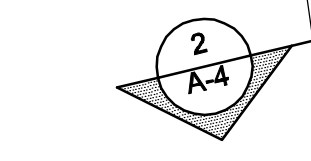

6 x 8 Timber Curb,  
See 2/A-4

Remove and Reset Existing  
Playground Equipment as  
Required for Installation of  
Drainage, Base, and Mulch

Rosman Elementary School

Existing  
Play Area

New Asphalt  
Basketball Court

Provide Curb Cuts

New Conc.  
Walk

Existing Drive

Existing Fence to Remain

New Asphalt Paving

Existing  
Headstart Building

H.C. Sign -  
See 3/A-4

Existing Parking  
Stripe Existing Parking

New Bus Parking

Existing  
Picnic  
Shelter

DITCH - APPROX. PROPERTY LINE

TREE LINE



GRAPHIC SCALE - FEET

Rosman Elementary Bus Parking - Site Improvements

Scale 1" = 20'

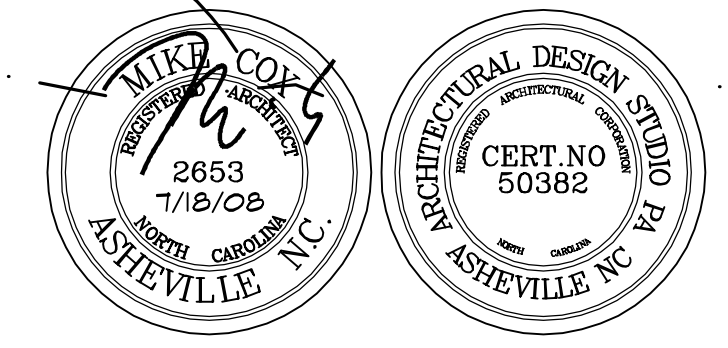

Rosman Elementary Bus Parking  
Rosman, North Carolina

Architectural Design Studio, P.A.  
90 Church Street, Asheville, NC 28801 Phone: 628.252.0355 Fax: 628.252.4059





Legend	
Symbol	Description
⊕	Spot Elevation
---	Existing Contours
- - -	New Contours
▨	New Concrete Sidewalks
---	Storm Drain
---	Fence Line

Date	7/18/08
Revisions	

Provide 6" Conc. Plug for Perforated Culvert

S.S.M.H.  
RM=2196.3  
6" INV.=2192.9  
6" INV.=2192.7

# Rosman Elementary School

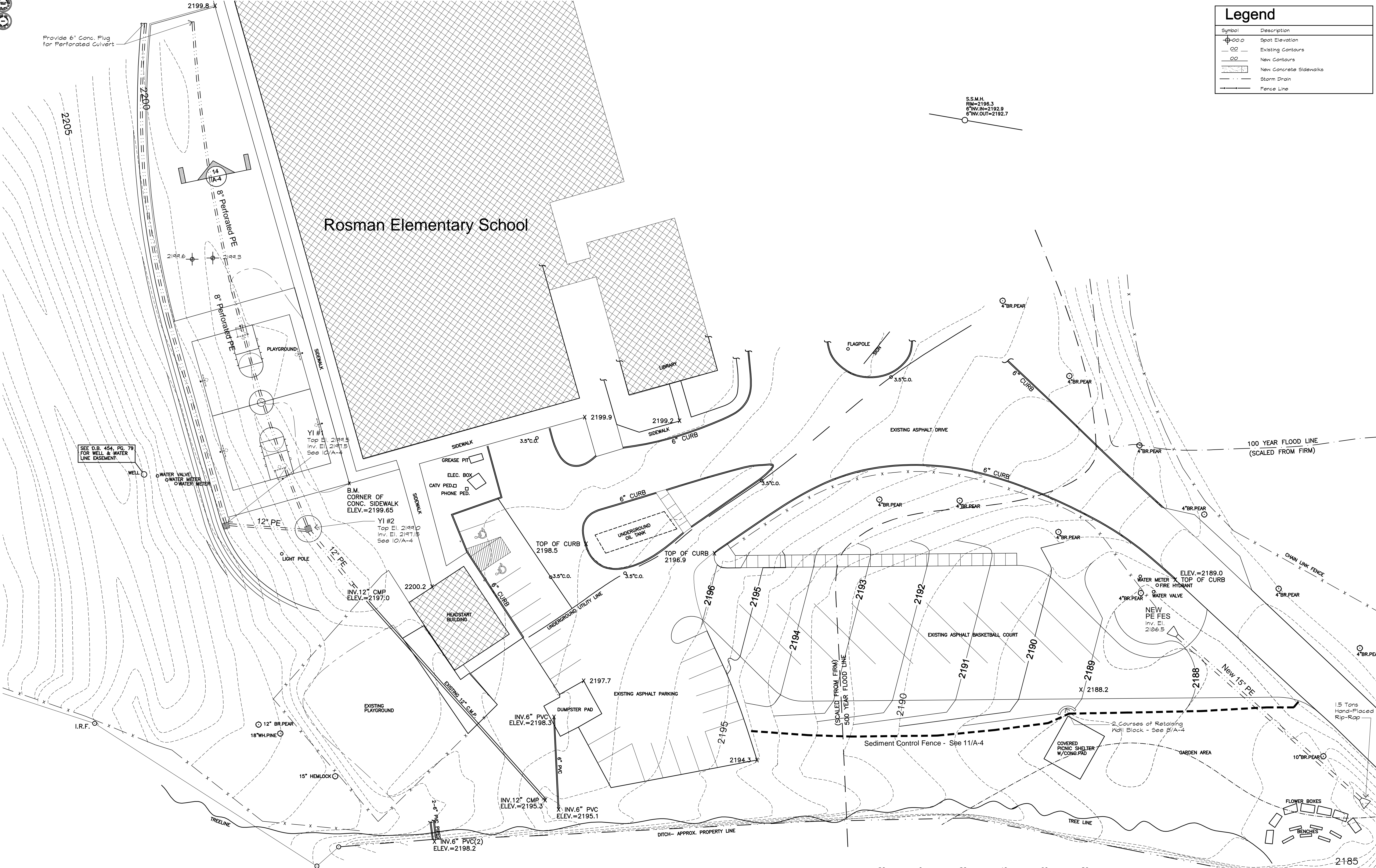

SEE D.B. 454, PG. 79 FOR WELL & WATER LINE EASEMENT

B.M. CORNER OF CONC. SIDEWALK  
ELEV.=2199.65

Y1 #2  
Top El. 2199.0  
Inv. El. 2197.5  
See 10/A-4

INV. 6" PVC  
ELEV.=2198.3

INV. 12" CMP  
ELEV.=2195.3

INV. 6" PVC  
ELEV.=2195.1

INV. 6" PVC(2)  
ELEV.=2198.2

ELEV.=2189.0  
TOP OF CURB

NEW PE FES  
Inv. El. 2186.5

NEW PE FES  
Inv. El. 2184



GRAPHIC SCALE - FEET  
**Rosman Elementary Bus Parking - Grading Plan**  
Scale 1" = 20'

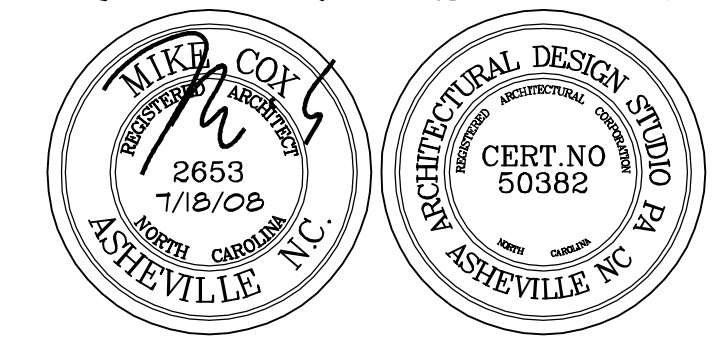

**Rosman Elementary Bus Parking**  
Rosman, North Carolina

**Architectural Design Studio, P.A.**  
90 Church Street, Asheville, NC 28801 Phone: 828.252.0355 Fax: 828.252.4059

Sheet  
**A-3**